

A General Specifications

Electrical Capacity (Resistive Load)

Power Level (silver):	6A @ 125V AC or 3A @ 250V AC or 3A @ 30V DC
Logic Level (gold):	0.4VA maximum @ 28V AC/DC maximum (Applicable Range 0.1mA ~ 0.1A @ 20mV ~ 28V) Note: Find additional explanation of operating range in Supplement section.

Other Ratings

Contact Resistance:	10 milliohms maximum for silver; 20 milliohms maximum for gold		
Insulation Resistance:	1,000 megohms minimum @ 500V DC		
Dielectric Strength:	1,000V AC minimum between contacts for 1 minute minimum; 1,500V AC minimum between contacts & case for 1 minute minimum		
Mechanical Life:	50,000 operations minimum		
Electrical Life:	25,000 operations minimum		
Nominal Operating Force:		On-to-On Position	Off-to-On Position
	Single Pole	3.19N	3.92N
	Double Pole	4.41N	7.06N
Angle of Throw:	20°		

Materials & Finishes

Bushing:	Brass with nickel plating
Housing:	Stainless steel
Mounting Bracket:	Steel with tin plating
Movable Contacts:	Silver alloy or silver alloy with gold plating
Stationary Contacts:	Silver with silver plating or copper or brass with gold plating
Lamp Contacts:	Phosphor bronze
Base:	Diallyl phthalate (UL94V-0)
Switch Terminals:	Copper with silver or gold plating
Lamp Terminals:	Brass with silver or gold plating

Environmental Data

Operating Temp Range:	-10°C through +55°C (+14°F through +131°F)
Humidity:	90 ~ 95% humidity for 96 hours @ 40°C (104°F)
Vibration:	10 ~ 55Hz with peak-to-peak amplitude of 1.5mm traversing the frequency range & returning in 1 minute; 3 right angled directions for 2 hours
Shock:	50G (490m/s ²) acceleration (tested in 6 right angled directions, with 5 shocks in each direction)

Installation

Mounting Torque:	1.47Nm (13 lb•in) for double nut; .67Nm (6 lb•in) for single nut
Soldering Time & Temp:	Wave Soldering (PC version): See Profile B in Supplement section. Manual Soldering: See Profile B in Supplement section. Note: Lever must be in center position while soldering.
Cleaning:	PC mountable device is not process sealed. Hand clean locally using alcohol based solution.

Standards & Certifications

Flammability Standards:	UL94V-0 base
UL:	File No. E44145 Single pole with synchronous circuits & solder lug or PC recognized at 6A @ 125V AC Add "/U" to end of part number to order UL mark on switch.
CSA:	File No. 023535_0_000 All single pole with synchronous circuits certified at 6A @ 125V AC Add "/C" to end of part number to order CSA mark on switch.

Distinctive Characteristics

Industry's first LED illumination at tip of toggle switches.

Single color LEDs of red, yellow, and green, plus bicolor red/green, to meet varied design requirements.

LEDs can operate independently from or synchronously with switching operation.

Antijamming feature to protect contacts from damage due to excessive downward force on the toggle.

High torque bushing prevents the bushing from rotating or separating from the metal frame during installation.

Stainless steel frame resists corrosion.

Silver contacts are of specially composed alloy for hardness.

High insulating barriers protect against crossover in double pole devices.

Terminals are molded in and epoxy sealed to lock out flux, dust, and other contaminants.

1,500V dielectric strength between switch contacts and case is accomplished by clinching the frame away from the terminals.

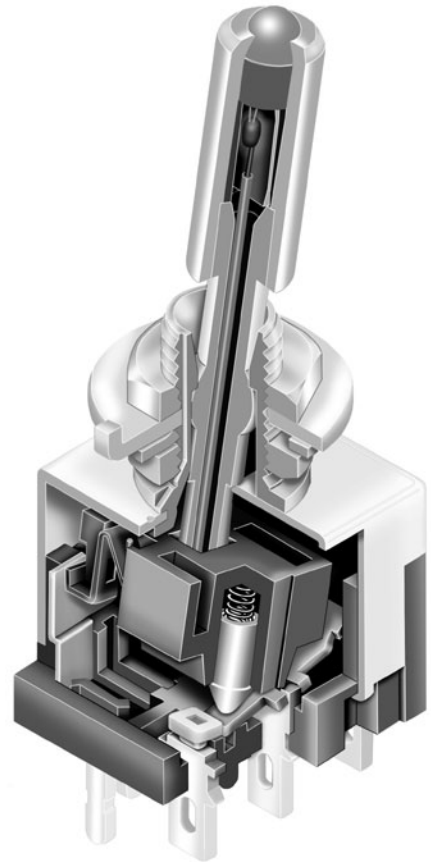

Actual Size

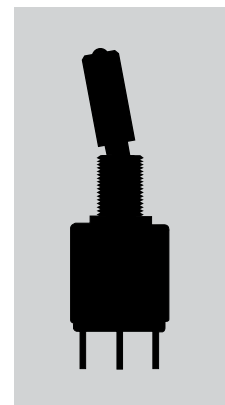

A
Toggles

Rockers

Pushbuttons

Illuminated PB

Programmable

Keylocks

Rotaries

Slides

Tactiles

Tilt

Touch

Indicators

Accessories

Supplement

TYPICAL SWITCH ORDERING EXAMPLE

M21

1

2

T

C

W

01

Poles	
1	SPDT
* 2	DPDT
* Available only with Terminals 01, 02, 03	

LED Circuits & Actuator Types	
L	Isolated
T	Synchronous

Contact Materials & Ratings	
W	Silver; Rated 6A @ 125V AC
G	Gold; Rated 0.4VA max @ 28V AC/DC max

Threaded Bushings	
No Code	1/4-40 Thread (Inch)
/M	6mm Thread (Metric)

Circuits			
2	ON	NONE	ON
3	ON	OFF	ON

LED Colors	
Single Color	
C	Red
E	Yellow
F	Green
Bicolor	
CF	Red/Green

Terminals & Mounting Types	
01	Solder Lug with Threaded Bushing *
02	Quick Connect with Threaded Bushing
03	Straight PC with Threaded Bushing
30	Right Angle PC with Smooth Bushing (available with gold contacts only)

IMPORTANT:



Switches are supplied without UL & CSA marking unless specified. Specific models & ratings noted on General Specifications page.



*Wire harness & cable assemblies offered only in Americas

DESCRIPTION FOR TYPICAL ORDERING EXAMPLE

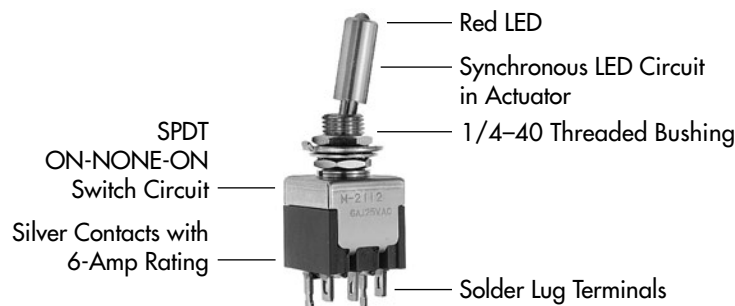
M2112TCW01

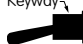

POLES & CIRCUITS & LED ILLUMINATION

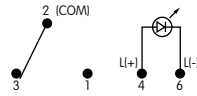
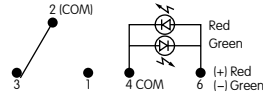
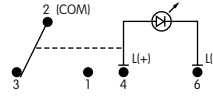
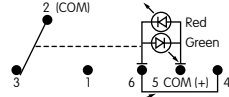
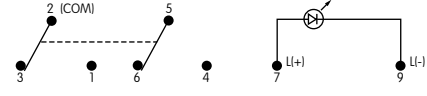
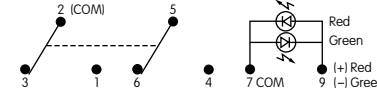
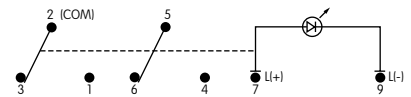
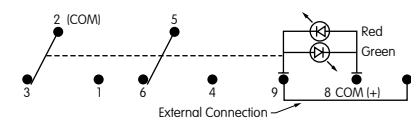
Model		Pole & Throw	Toggle Position & Terminal Numbers			Schematics	
			Down <small>Keyway</small> 	Center 	Up 	Notes: Terminal numbers are not actually on the switch. LEDs require an external power source.	
M2112 SPDT Connected Power Terminals			ON 2-3	NONE NONE	ON 2-1	Isolated Single Color LED	
LED Circuit	Isolated LEDs (see schematics) Connected LED Terminals		ON 4-6	NONE NONE	ON 4-6	Isolated Bicolor LED	
	Synchronous Single Color LED Connected LED Terminals		ON 4-6	NONE NONE	OFF OPEN		
	Synchronous Bicolor LED Connected LED Terminals		Red 5-6	NONE NONE	Green 5-4		
M2113 SPDT Connected Power Terminals			ON 2-3	OFF OPEN	ON 2-1	Synchronous Single Color LED	
LED Circuit	Isolated LEDs (see schematics) Connected LED Terminals		ON 4-6	ON 4-6	ON 4-6	Synchronous Bicolor LED	
	Synchronous Single Color LED Connected LED Terminals		ON 4-6	OFF OPEN	ON 4-6		
	Synchronous Bicolor LED Connected LED Terminals		Red 5-6	OFF OPEN	Green 5-4		
M2122 DPDT Connected Power Terminals			ON 2-3 5-6	NONE NONE	ON 2-1 5-4	Isolated Single Color LED	
LED Circuit	Isolated LEDs (see schematics) Connected LED Terminals		ON 7-9	NONE NONE	ON 7-9	Isolated Bicolor LED	
	Synchronous Single Color LED Connected LED Terminals		ON 7-9	NONE NONE	OFF OPEN		
	Synchronous Bicolor LED Connected LED Terminals		Red 8-9	NONE NONE	Green 8-7		
M2123 DPDT Connected Power Terminals			ON 2-3 5-6	OFF OPEN	ON 2-1 5-4	Synchronous Single Color LED	
LED Circuit	Isolated LEDs (see schematics) Connected LED Terminals		ON 7-9	ON 7-9	ON 7-9	Synchronous Bicolor LED	
	Synchronous Single Color LED Connected LED Terminals		ON 7-9	OFF OPEN	ON 7-9		
	Synchronous Bicolor LED Connected LED Terminals		Red 8-9	OFF OPEN	Green 8-7		

LED COLORS & SPECIFICATIONS

Single Element LED

LED factory assembled Not available separately Bicolor LED is translucent white when unlit.		Single Color			Bicolor
		C Red	E Yellow	F Green	CF Red/Green
Forward Peak Current	I_{FM}	25	30	30	25
Continuous Forward Current	I_F	20	20	20	10
Forward Voltage	V_F	2.1	2.1	2.1	1.9
Reverse Peak Voltage	V_{RM}	4	4	4	—
Current Reduction Rate Above 25°C	ΔI_F	0.33	0.40	0.40	0.33/0.33
Ambient Temperature Range		-10° ~ +55°C			

LED CIRCUIT, TOGGLE, & MOUNTING TYPE COMBINATIONS

L

Toggle with Isolated LED Circuit

T

Toggle with Synchronous LED Circuit

Finish: Brushed aluminum

Standard Hardware: 2 AT513H Hex Nuts, 1 AT507H Locking Ring, 1 AT509 Lockwasher Standard & optional hardware details in Accessories & Hardware section.

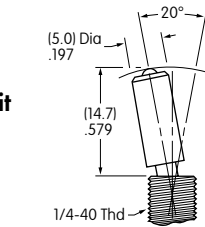

Threaded Bushing combines with Terminal codes 01, 02, & 03.

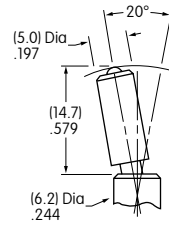

Smooth Bushing combines with Terminal code 30.

Max. Panel Thickness with Standard Hardware .102" (2.6mm)

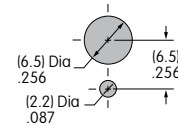

Max. Panel Thickness without Locking Ring .134" (3.4mm)

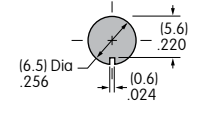

TYPICAL SWITCH DIMENSIONS

Solder Lug

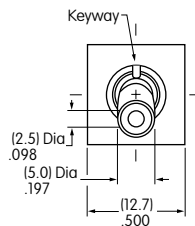

Single Pole

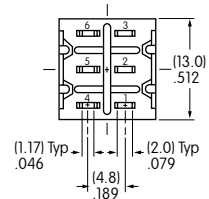
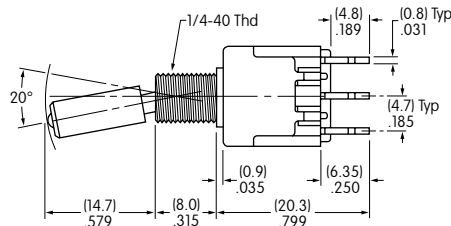

M2112TCFW01

Single color LED switch does not have terminal 5.

Solder Lug

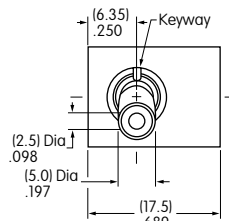

Double Pole

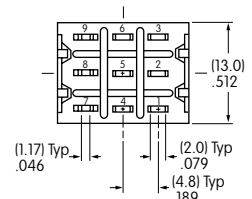
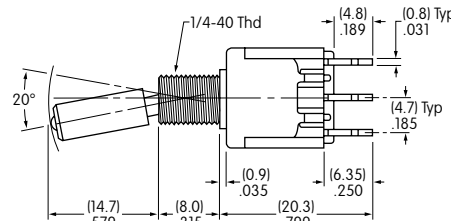

M2122TCFW01

Single color LED switch does not have terminal 8.

Right Angle PC

Single Pole Only

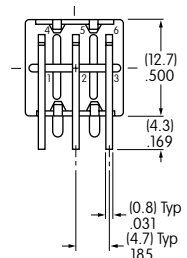
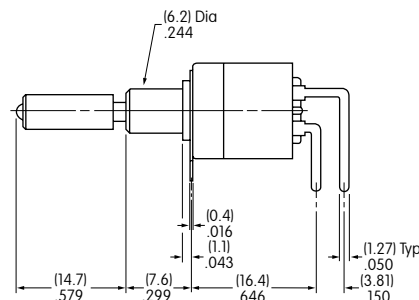
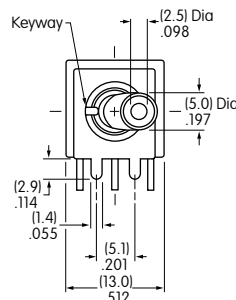
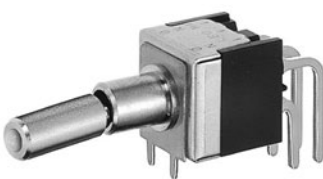

M2112TCFG30

Single color LED switch does not have terminal 5.

Gold contact material only

CONTACT MATERIALS & RATINGS

A
Toggles

Silver over Silver

Power Level

6A @ 125V AC & 3A @ 250V AC



Gold over Brass or Copper

Logic Level

0.4VA maximum @ 28V AC/DC maximum

Complete explanation of operating range in Supplement section.

Rockers

Pushbuttons

Illuminated PB

Programmable

Keylocks

Rotaries

Slides

Tactiles

Tilt

Touch

Indicators

Accessories

Supplement

TERMINALS

01

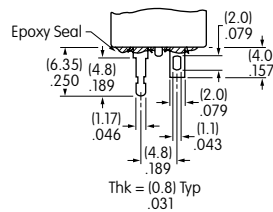
Solder Lug with
Turret LED Terminal

02

Quick Connect

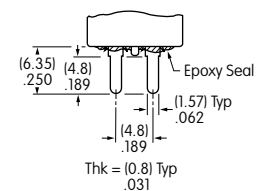

03

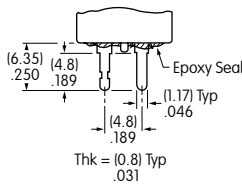
Straight PC with
Turret LED Terminal

Single Pole

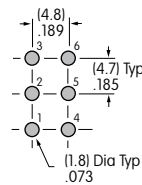
Single color LED
& isolated bicolor
LED switches do not
have terminal 5.

Double Pole

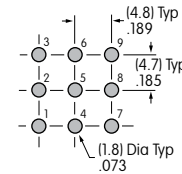
Single color LED
& isolated bicolor
LED switches do not
have terminal 8.

30

Right Angle PC

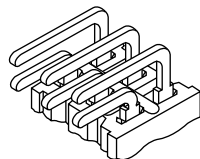

Single Pole

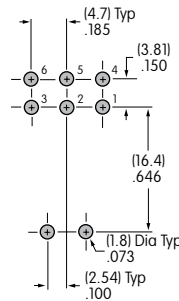
Single color LED
& isolated bicolor
LED switches do not
have terminal 5.

STANDARD MOUNTING HARDWARE

AT513H

Hexagon Nuts (2 per switch)

Material: Brass with nickel plating

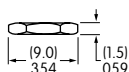
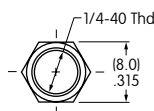

AT507H

Locking Ring (1 per switch)

Material: Steel with chromate over zinc

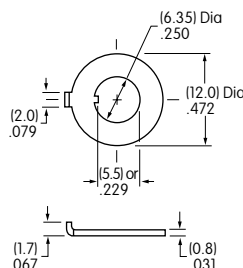

AT509

Lockwasher (1 per switch)

Material: Steel with chromate over zinc

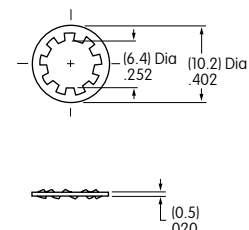

Optional Hardware: Knurled nuts, dress nuts, and ON-OFF plates are available; see details in Accessories & Hardware section.

General Specifications

B Electrical Capacity (Resistive Load)

Power Level (silver): 6A @ 125V AC or 3A @ 250V AC or 3A @ 30V DC
Logic Level (gold): 0.4VA maximum @ 28V AC/DC maximum
 (Applicable Range 0.1mA ~ 0.1A @ 20mV ~ 28V)
 Note: Find additional explanation of operating range in Supplement section.

Other Ratings

Contact Resistance: 10 milliohms maximum for silver; 20 milliohms maximum for gold
Insulation Resistance: 1,000 megohms minimum @ 500V DC
Dielectric Strength: 1,000V AC minimum between contacts for 1 minute minimum;
 1,500V AC minimum between contacts & case for 1 minute minimum

Mechanical Life: 50,000 operations minimum

Electrical Life: 25,000 operations minimum

Nominal Operating Force:		On-to-On Position	Off-to-On Position
Paddles	Single Pole	3.19N	3.92N
	Double Pole	4.41N	7.06N
Rockers	Single Pole	6.37N	9.80N
	Double Pole	13.73N	17.65N

Angle of Throw: 20°

Materials & Finishes

Housing: Stainless steel
Mounting Bracket: Steel with tin plating
Movable Contacts: Silver alloy or silver alloy with gold plating
Stationary Contacts: Silver with silver plating or copper or brass with gold plating
Lamp Contacts: Phosphor bronze
Base: Diallyl phthalate (UL94V-0)
Switch Terminals: Copper with silver or gold plating
Lamp Terminals: Brass with silver or gold plating

Environmental Data

Operating Temp Range: -10°C through +55°C (+14°F through +131°F) for rockers
 -25°C through +70°C (-13°F through +158°F) for paddles
Humidity: 90 ~ 95% humidity for 96 hours @ 40°C (104°F)
Vibration: 10 ~ 55Hz with peak-to-peak amplitude of 1.5mm traversing the frequency range & returning in 1 minute; 3 right angled directions for 2 hours
Shock: 50G (490m/s²) acceleration (tested in 6 right angled directions, with 5 shocks in each direction)

Installation

Soldering Time & Temp: Wave Soldering (PC version): See Profile B in Supplement section.
 Manual Soldering: See Profile B in Supplement section.
 Note: Lever must be in center position while soldering.
Cleaning: PC mountable device is not process sealed. Hand clean locally using alcohol based solution.

Standards & Certifications

Flammability Standards: UL94V-0 base
UL: File No. E44145
 Single pole rockers with synchronous circuits & solder lug or PC recognized at 6A @ 125V AC.
 Add "/U" to end of part number to order UL mark on switch.
CSA: File No. 023535_0_000
 All single pole rockers with synchronous circuits certified at 6A @ 125V AC.
 Add "/C" to end of part number to order CSA mark on switch.

TYPICAL SWITCH ORDERING EXAMPLE

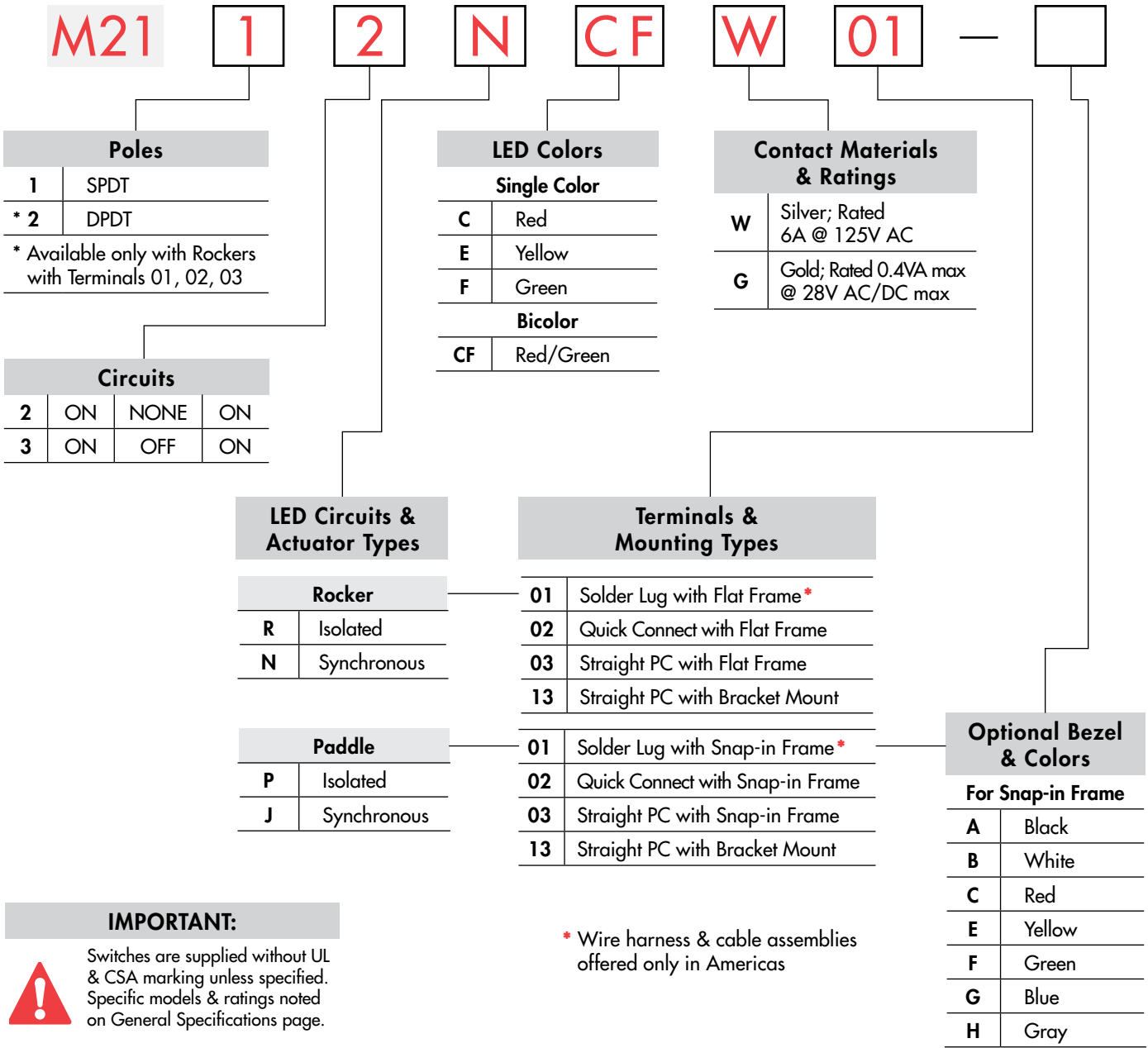

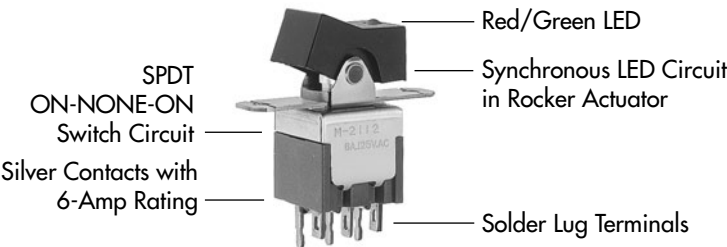

DESCRIPTION FOR TYPICAL ORDERING EXAMPLE

M21 12NCFW01

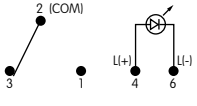
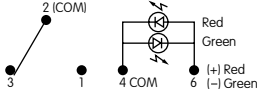
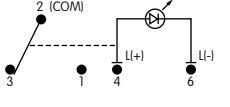
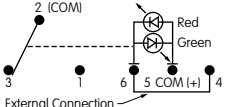
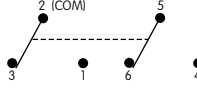
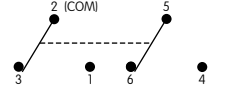
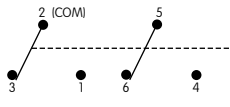
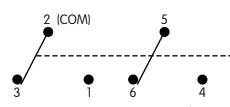

POLES & CIRCUITS & LED ILLUMINATION

Model	Pole & Throw	Toggle Position & Terminal Numbers			Schematics
		Down 	Center 	Up 	
M2112 Connected Power Terminals	SPDT	ON 2-3	NONE NONE	ON 2-1	<p>Notes: Terminal numbers are not actually on the switch. LEDs require an external power source.</p> <p>Isolated Single Color LED</p>  <p>Isolated Bicolor LED</p>  <p>Synchronous Single Color LED</p>  <p>Synchronous Bicolor LED</p> 
M2113 Connected Power Terminals	SPDT	ON 2-3	OFF OPEN	ON 2-1	
M2122 Connected Power Terminals	DPDT	ON 2-3 5-6	NONE NONE	ON 2-1 5-4	
M2123 Connected Power Terminals	DPDT	ON 2-3 5-6	OFF OPEN	ON 2-1 5-4	<p>Isolated Single Color LED</p>  <p>Isolated Bicolor LED</p>  <p>Synchronous Single Color LED</p>  <p>Synchronous Bicolor LED</p> 
M2112 Connected Power Terminals	SPDT	ON 2-3	NONE NONE	ON 2-1	
M2113 Connected Power Terminals	SPDT	ON 2-3	OFF OPEN	ON 2-1	
M2122 Connected Power Terminals	DPDT	ON 2-3 5-6	NONE NONE	ON 2-1 5-4	
M2123 Connected Power Terminals	DPDT	ON 2-3 5-6	OFF OPEN	ON 2-1 5-4	

LED COLORS & SPECIFICATIONS

Single Element LED		Rockers				Paddles				Units
LED factory assembled Not available separately Bicolor LED is translucent white when unlit.	Color	Single Color			Bicolor	Single Color			Bicolor	
		<div>C</div>	<div>E</div>	<div>F</div>	<div>CF</div>	<div>C</div>	<div>E</div>	<div>F</div>	<div>CF</div>	
		Red	Yellow	Green	Red/Green	Red	Yellow	Green	Red/Green	
Forward Peak Current	I _{FM}	25	30	30	25	10	30	30	30/25	mA
Continuous Forward Current	I _F	20	20	20	20	8	24	24	20/20	mA
Forward Voltage	V _F	2.1	2.1	2.1	2.1	1.9	2.0	2.1	2.0/2.2	V
Reverse Peak Voltage	V _{RM}	4	4	4	—	5	5	5	—	V
Current Reduction Rate Above 25°C	ΔI _F	0.33	0.40	0.40	0.33/0.33	0.13	0.40	0.40	0.43/0.38	mA/°C
Ambient Temperature Range		-10° ~ +55°C				-25° ~ +70°C				

LED CIRCUIT, ROCKER, & MOUNTING TYPE COMBINATIONS

- R** Rocker with Isolated LED Circuit
- N** Rocker with Synchronous LED Circuit

Material: Polyamide

Finish: Matte

Color: Black

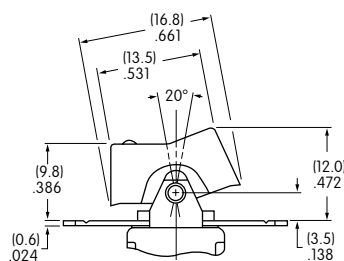

Flat Frame combines with Terminal codes 01, 02, & 03.

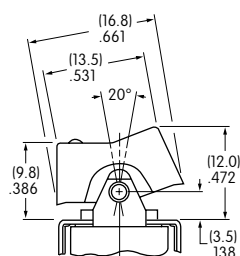

Bracket combines with Terminal code 13.

Maximum Panel Thickness
.126" (3.2mm)

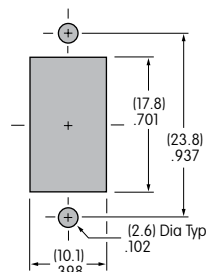

TYPICAL ROCKER SWITCH DIMENSIONS

Single Pole

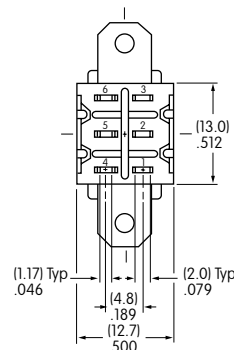
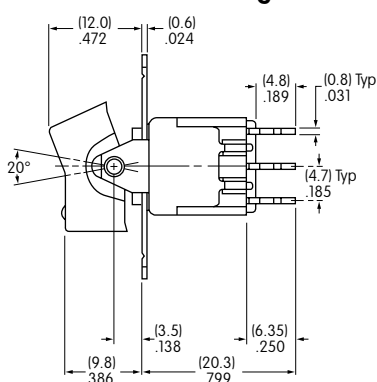
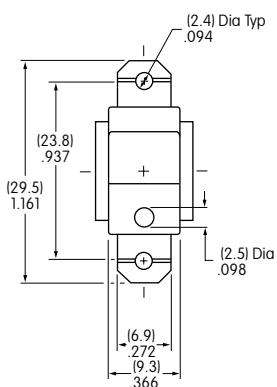

Single color LED switch does not have terminal 5.

Solder Lug

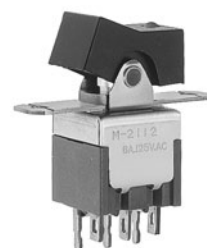

M2112NCFW01

Double Pole

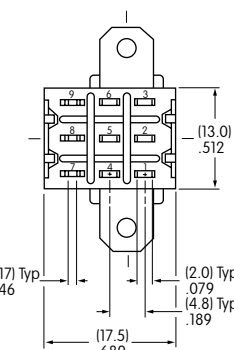
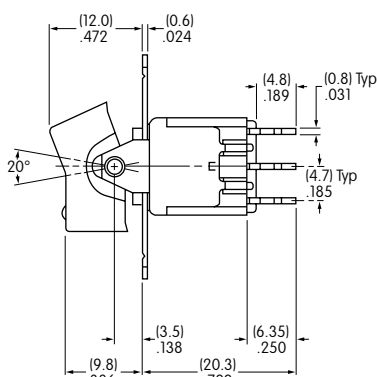
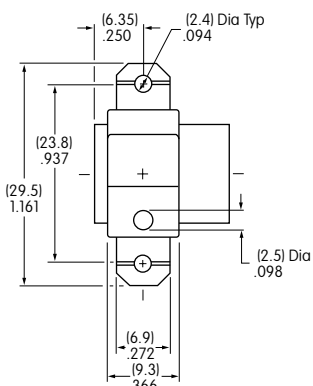

Single color LED switch does not have terminal 8.

Solder Lug



M2122NCFW01

Single Pole Only

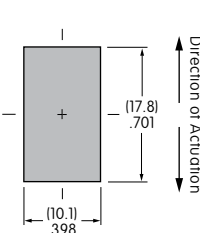
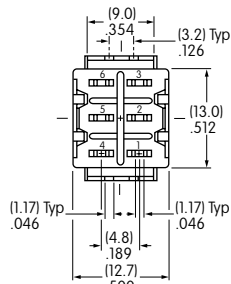
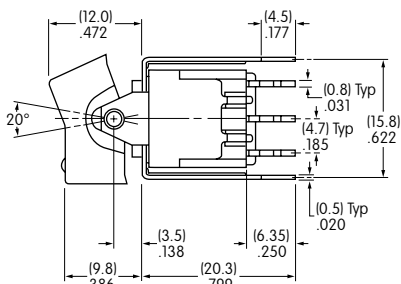
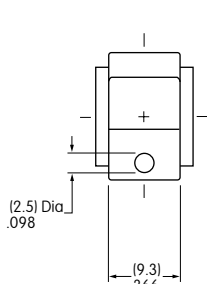

Straight PC • Bracket



M2112NCFW13

Single color LED switch does not have terminal 5. Silver contact material is standard.

LED CIRCUIT, PADDLE, & MOUNTING TYPE COMBINATIONS

P

Paddle with Isolated LED Circuit

J

Paddle with Synchronous LED Circuit

Maximum Panel Thickness
.039" ~ .126" (1.0 ~ 3.2mm)
without Bezel
.039" ~ .098" (1.0 ~ 2.5mm)
with Bezel

Maximum
Panel
Thickness
.126" (3.2mm)

Material: Polyamide
Finish: Matte
Color: Black

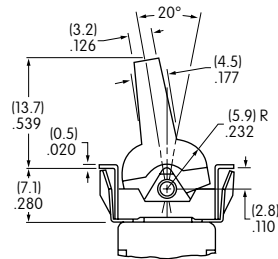

Snap-in combines with Terminal codes 01, 02, & 03

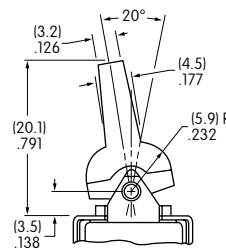

Bracket combines with Terminal code 13

TYPICAL PADDLE SWITCH DIMENSIONS

Solder Lug • Snap-in

Single Pole Only

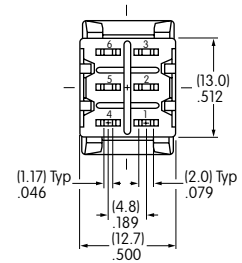
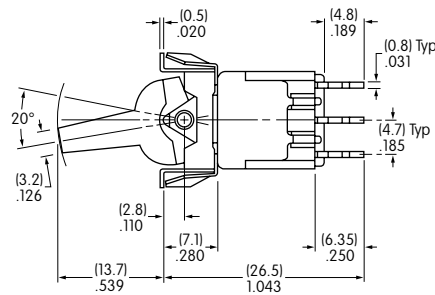
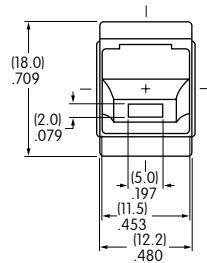

M2112JCFW01

Single color LED switch does not have terminal 5.

Straight PC • Bracket

Single Pole Only

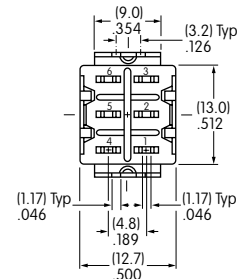
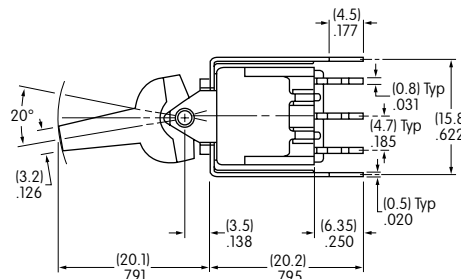
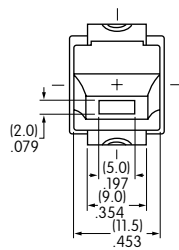

M2112JCFW13

Silver contact material is standard. Single color LED switch does not have terminal 5.

CONTACT MATERIALS & RATINGS

W

Silver over Silver

Power Level

6A @ 125V AC & 3A @ 250V AC

G

Gold over Brass or Copper

Logic Level

0.4VA maximum @ 28V AC/DC maximum

Complete explanation of operating range in Supplement section.

TERMINALS

01

Solder Lug with Turret LED Terminal

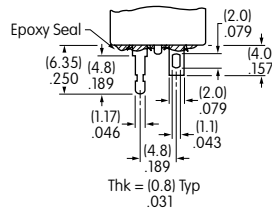

02

Quick Connect

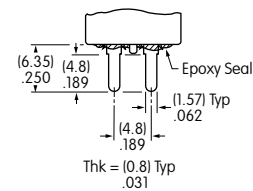

03

Straight PC with Turret LED Terminal

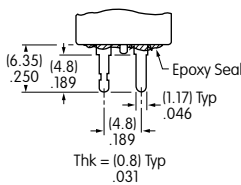

Single Pole

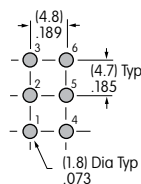

Single color LED & isolated bicolor LED switches do not have terminal 5.

Double Pole

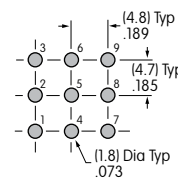

Single color LED & isolated bicolor LED switches do not have terminal 8.

13

Straight PC with Bracket & Turret LED Terminal

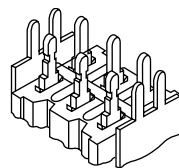

Single Pole

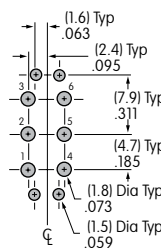

Single color LED & isolated bicolor LED switches do not have terminal 5.

OPTIONAL BEZEL & COLORS

AT2107 Bezel for Snap-in Panel Frame

Material: Polyamide

Finish: Matte

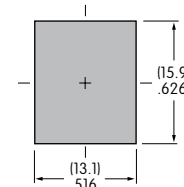
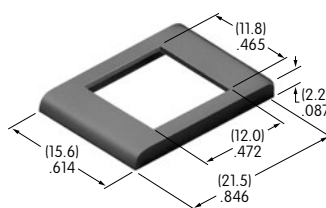

Colors Available:

A

Black

B

White

C

Red

E

Yellow

F

Green

G

Blue

H

Gray



**Стандарт
Электрон
Связь**

Мы молодая и активно развивающаяся компания в области поставок электронных компонентов. Мы поставляем электронные компоненты отечественного и импортного производства напрямую от производителей и с крупнейших складов мира.

Благодаря сотрудничеству с мировыми поставщиками мы осуществляем комплексные и плановые поставки широчайшего спектра электронных компонентов.

Собственная эффективная логистика и склад в обеспечивает надежную поставку продукции в точно указанные сроки по всей России.

Мы осуществляем техническую поддержку нашим клиентам и предпродажную проверку качества продукции. На все поставляемые продукты мы предоставляем гарантию .

Осуществляем поставки продукции под контролем ВП МО РФ на предприятия военно-промышленного комплекса России , а также работаем в рамках 275 ФЗ с открытием отдельных счетов в уполномоченном банке. Система менеджмента качества компании соответствует требованиям ГОСТ ISO 9001.

Минимальные сроки поставки, гибкие цены, неограниченный ассортимент и индивидуальный подход к клиентам являются основой для выстраивания долгосрочного и эффективного сотрудничества с предприятиями радиоэлектронной промышленности, предприятиями ВПК и научно-исследовательскими институтами России.

С нами вы становитесь еще успешнее!

Наши контакты:

Телефон: +7 812 627 14 35

Электронная почта: sales@st-electron.ru

Адрес: 198099, Санкт-Петербург,
Промышленная ул, дом № 19, литера Н,
помещение 100-Н Офис 331