

- High-Resolution Conversion of Light Intensity to Frequency With No External Components
- High Irradiance Responsivity . . .  $3.4 \text{ kHz}/(\mu\text{W}/\text{cm}^2)$  at  $\lambda_p = 640 \text{ nm}$
- Low Dark Frequency . . .  $< 6 \text{ Hz}$  at  $50^\circ \text{ C}$
- Single-Supply Operation . . .  $2.7 \text{ V}$  to  $5.5 \text{ V}$
- Stable  $200 \text{ ppm}/^\circ\text{C}$  Temperature Coefficient
- Interfaces Directly to a Microcontroller
- Lead (Pb) Free Package
- RoHS Compliant

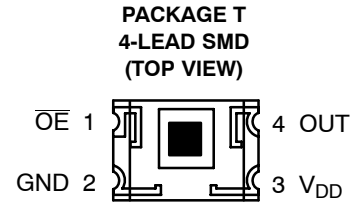

## Description

The TSL238T light-to-frequency converter combines a silicon photodiode and a current-to-frequency converter on a single monolithic CMOS integrated circuit. Output is a square wave (50% duty cycle) with frequency directly proportional to light intensity (irradiance) on the photodiode. The digital output allows direct interface to a microcontroller or other logic circuitry. Output enable ( $\overline{\text{OE}}$ ) places the output in a high-impedance state for multiple-unit sharing of a microcontroller input line. The device has been temperature compensated for the ultraviolet-to-visible light range of 320 nm to 700 nm and responds over the light range of 320 nm to 1050 nm. The TSL238T is characterized for operation over the temperature range of  $-40^\circ\text{C}$  to  $85^\circ\text{C}$  and is supplied in a compact 4-lead surface-mount package that is lead (Pb) free and RoHS compliant.

## Functional Block Diagram



## Available Options

DEVICE	T <sub>A</sub>	PACKAGE – LEADS	PACKAGE DESIGNATOR	ORDERING NUMBER
TSL238T	$-40^\circ\text{C}$ to $85^\circ\text{C}$	4-lead Low Profile Surface Mount	T	TSL238T

## Terminal Functions

TERMINAL NAME	T PKG NO.	TYPE	DESCRIPTION
GND	2		Power supply ground (substrate). All voltages are referenced to GND.
$\overline{\text{OE}}$	1	I	Enable for $f_O$ (active low).
OUT	4	O	Output frequency.
V <sub>DD</sub>	3		Supply voltage.

# TSL238T

## HIGH-SENSITIVITY

### LIGHT-TO-FREQUENCY CONVERTER

TAOS080G – DECEMBER 2007

#### Absolute Maximum Ratings over operating free-air temperature range (unless otherwise noted)<sup>†</sup>

Supply voltage, $V_{DD}$ (see Note 1)	6 V
Input voltage range, $V_I$	–0.3 V to $V_{DD} + 0.3$ V
Output current, $I_O$	± 5 mA
Short circuit of output to ground duration	5 s
Operating free-air temperature range, $T_A$ (see Note 2)	–40°C to 85°C
Storage temperature range, $T_{stg}$ (see Note 2)	–40°C to 85°C
Solder conditions in accordance with JEDEC, J-STD-020C	260°C

<sup>†</sup> Stresses beyond those listed under “absolute maximum ratings” may cause permanent damage to the device. These are stress ratings only, and functional operation of the device at these or any other conditions beyond those indicated under “recommended operating conditions” is not implied. Exposure to absolute-maximum-rated conditions for extended periods may affect device reliability.

NOTES: 1. All voltage values are with respect to GND.

2. Long-term storage or operation above 70°C could cause package yellowing that will lower the sensitivity to wavelengths < 500nm.

#### Recommended Operating Conditions

	MIN	NOM	MAX	UNIT
Supply voltage, $V_{DD}$	2.7	5	5.5	V
High-level input voltage, $V_{IH}$	$0.8 \times V_{DD}$		$V_{DD}$	V
Low-level input voltage, $V_{IL}$	0		0.5	V
Operating free-air temperature range, $T_A$	–40		70	°C

#### Electrical Characteristics at $V_{DD} = 5$ V, $T_A = 25^\circ\text{C}$ , $\lambda_p = 640$ nm (Note 1) (unless otherwise noted)

PARAMETER	TEST CONDITIONS	MIN	TYP	MAX	UNIT
$V_{OH}$ High-level output voltage	$I_{OH} = -1$ mA	4	4.5		V
$V_{OL}$ Low-level output voltage	$I_{OL} = 1$ mA		0.25	0.4	V
$I_{IH}$ High-level input current		–10		10	μA
$I_{IL}$ Low-level input current		–10		10	μA
$I_{DD}$ Supply current	$E_e = 14.7 \mu\text{W}/\text{cm}^2$		2	3	mA
Full-scale frequency (Note 2)	$T_A = 50^\circ\text{C}$ (Note 3)	500		1000	kHz
Temperature coefficient of responsivity	Wavelength < 600nm, $f_O = 50$ kHz		±200		ppm/°C
$k_{SVS}$ Supply-voltage sensitivity	$V_{DD} = 5$ V ±10%		±0.5		%/V

NOTES: 1. The input irradiance is supplied with red LED light source with peak wavelength = 640 nm.

2. Full-scale frequency is the maximum frequency of the device without saturation. Higher irradiance will not result in any additional increase of output frequency. The output frequency will remain at approximately the saturation frequency to a minimum of 1000 μW/sq-cm 640-nm irradiance. During production testing, devices are not tested at this very high irradiance level.

3. Measured at wafer probe using 50°C hot chuck.

**Operating Characteristics at  $V_{DD} = 5\text{ V}$ ,  $T_A = 25^\circ\text{C}$ ,  $\lambda_p = 640\text{ nm}$  (unless otherwise noted)**

PARAMETER	TEST CONDITIONS	MIN	TYP	MAX	UNIT
$f_O$ Output frequency	$E_e = 14.7\text{ }\mu\text{W}/\text{cm}^2$	40	50	60	kHz
$f_D$ Dark frequency	$E_e = 0\text{ }\mu\text{W}/\text{cm}^2$	0	0.3		Hz
	$E_e = 0\text{ }\mu\text{W}/\text{cm}^2$ , $T_A = 50^\circ\text{C}$ (Note 1)	0		6	Hz
$R_e$ Irradiance responsivity			3.4		kHz/( $\mu\text{W}/\text{cm}^2$ )
$\lambda_p$ Peak response wavelength			700		nm
Nonlinearity (Note 2)	$f_O = 0\text{ kHz to }10\text{ kHz}$		$\pm 1\%$		% F.S.
Step response to full-scale step input			1 pulse of new frequency plus $1\text{ }\mu\text{s}$		
Time from $\overline{OE}$ low to output enabled			1 period of output frequency		

NOTES: 1. Measured at wafer probe using  $50^\circ\text{C}$  hot chuck.  
 2. Nonlinearity is defined as the deviation from a straight line between zero and maximum of stated range, expressed as a percent of stated range.

# TSL238T HIGH-SENSITIVITY LIGHT-TO-FREQUENCY CONVERTER

TAOS080G – DECEMBER 2007

## TYPICAL CHARACTERISTICS

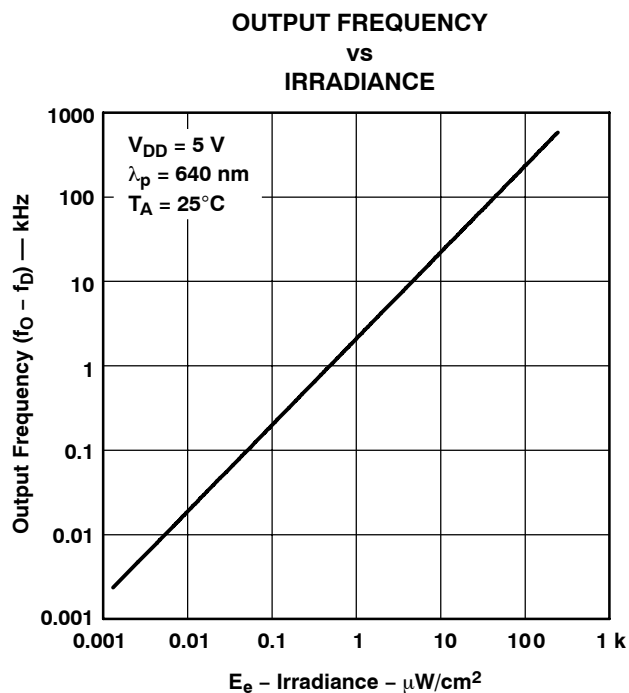

Figure 1

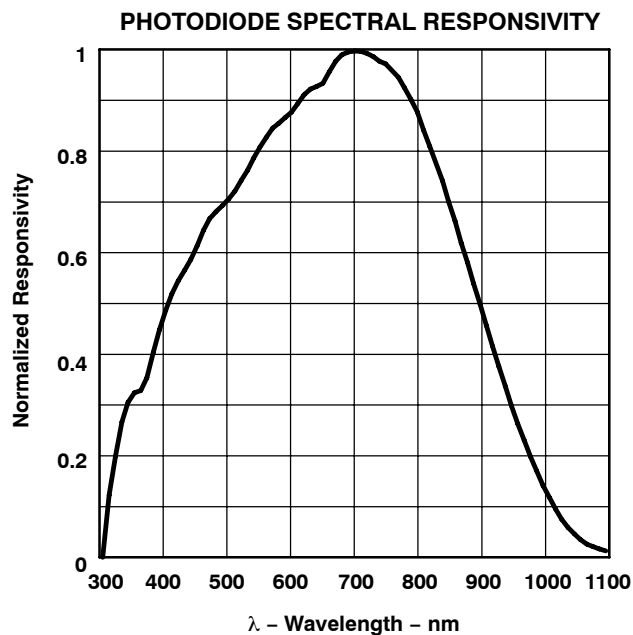

Figure 2

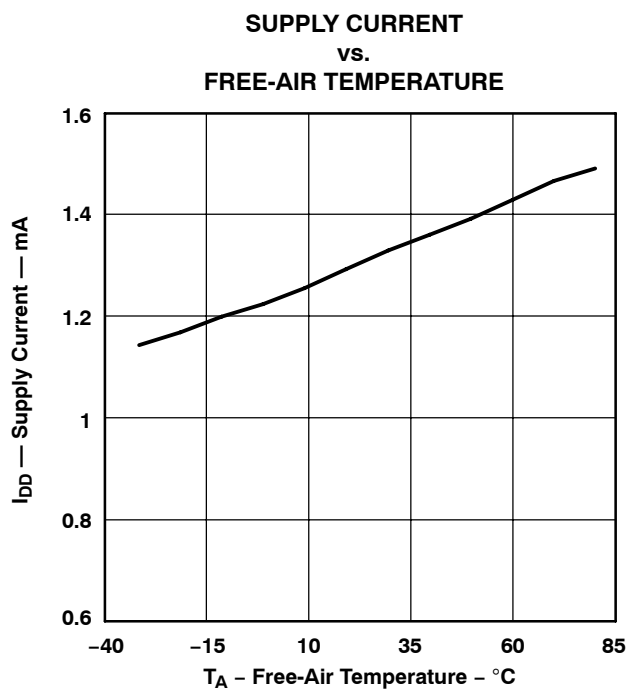

Figure 3

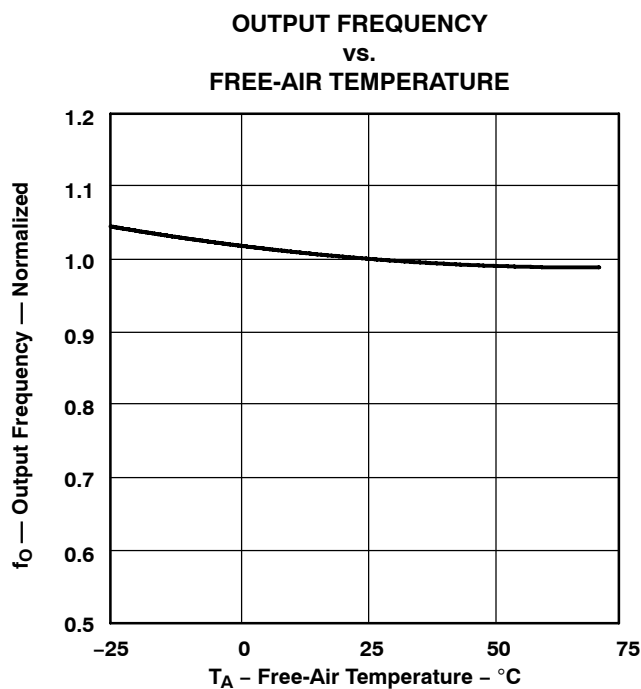
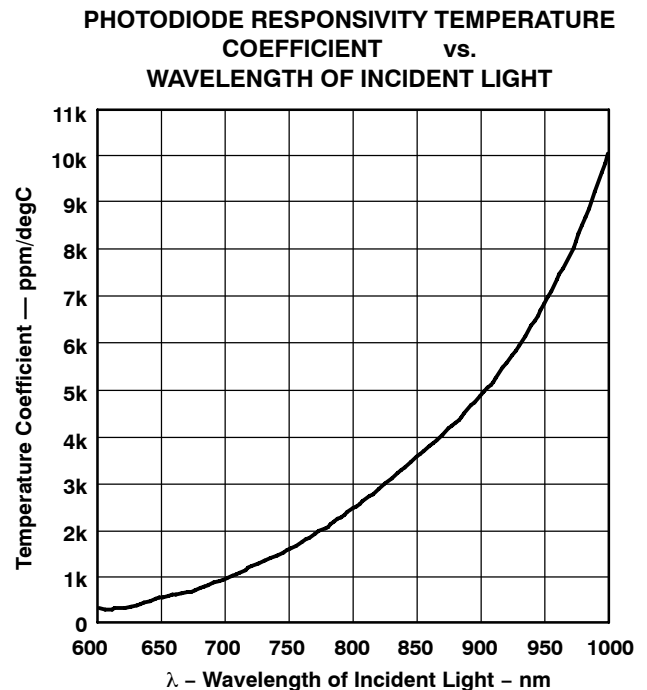
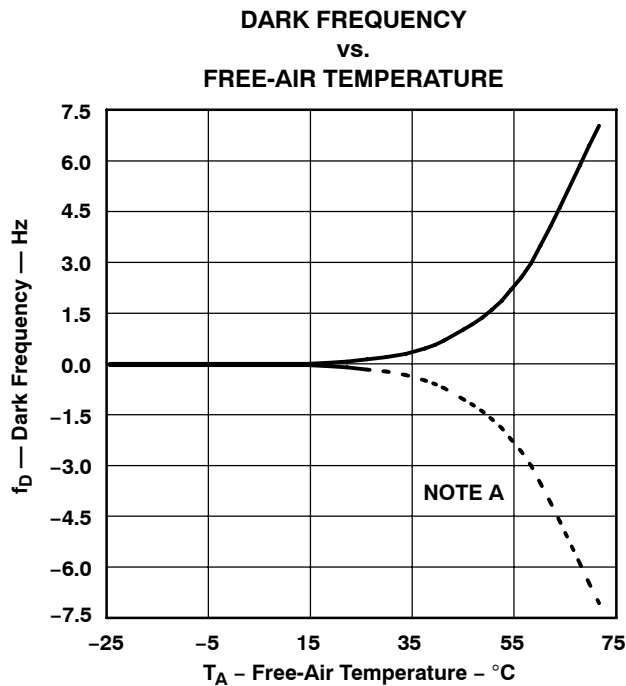
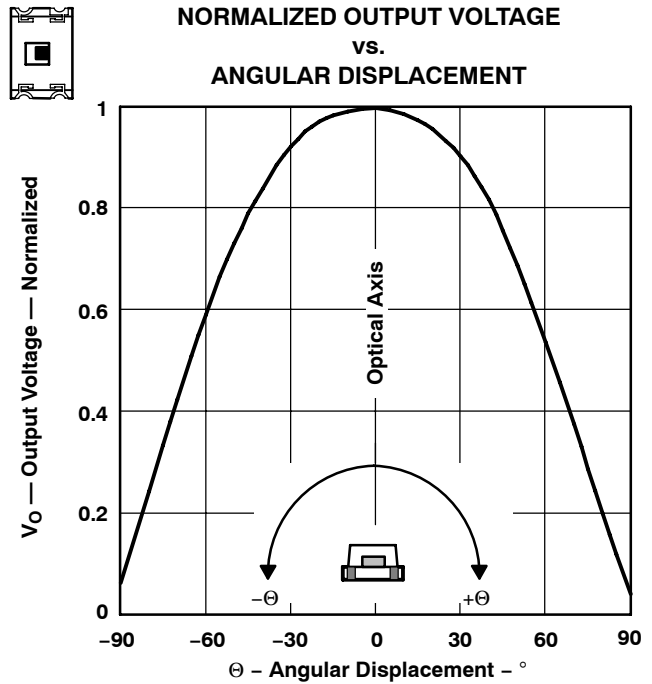
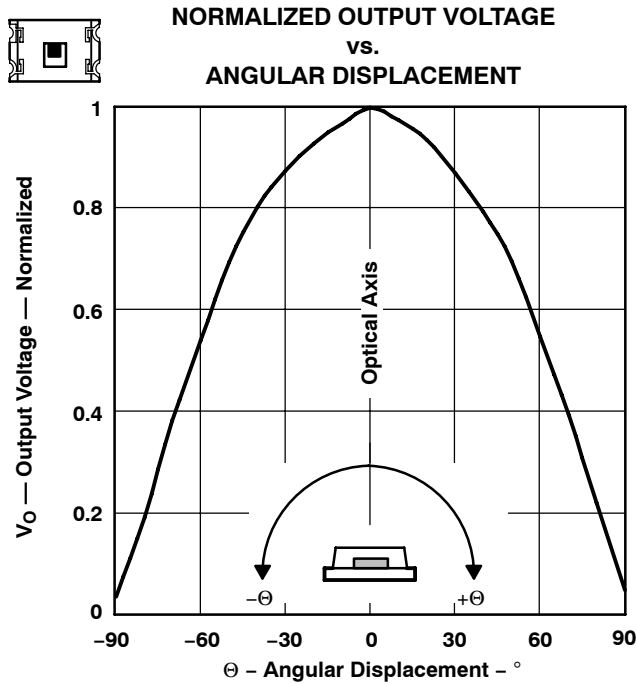

Figure 4



## TYPICAL CHARACTERISTICS



NOTE A: Internal offsets that result in dark frequency can be both positive and negative. The dashed line represents the case of negative offset in which an equivalent amount of light signal is required to obtain a non-zero output frequency.

# TSL238T HIGH-SENSITIVITY LIGHT-TO-FREQUENCY CONVERTER

TAOS080G – DECEMBER 2007

## APPLICATION INFORMATION

### Power-Supply Considerations

Power-supply lines must be decoupled by a 0.01- $\mu$ F to 0.1- $\mu$ F capacitor with short leads placed close to the TSL238T (Figure 9). A low-noise power supply is required to minimize jitter on output pulse.

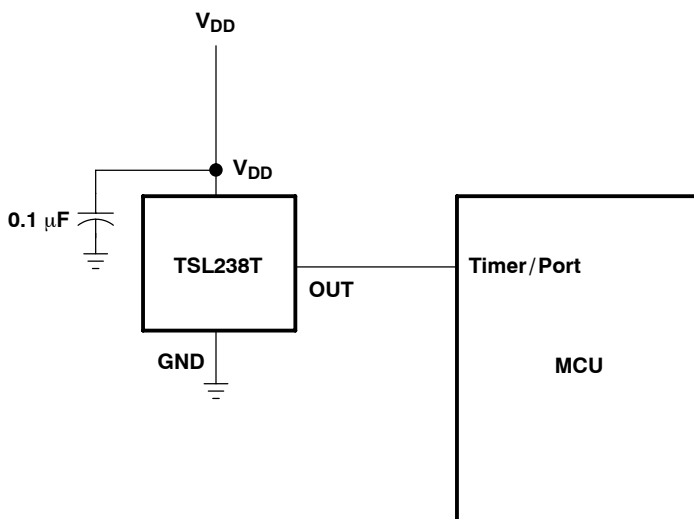

Figure 9. Typical TSL238T Interface to a Microcontroller

### Device Operational Details

The frequency at the output pin (OUT) is given by:

$$f_O = f_D + (R_e)(E_e)$$

where:

- $f_O$  is the output frequency
- $f_D$  is the output frequency for dark condition ( $E_e = 0$ )
- $R_e$  is the device responsivity for a given wavelength of light given in  $\text{kHz}/(\mu\text{W}/\text{cm}^2)$
- $E_e$  is the incident irradiance in  $\mu\text{W}/\text{cm}^2$

$f_D$  is a constant error term in the output frequency calculation resulting from leakage currents, and is independent of light intensity. The TSL238T die is trimmed to minimize the magnitude of this dark frequency component so that it can be neglected in the transfer function calculation. In many applications, measurement of the actual dark frequency may be impractical due to measurement times ranging from several seconds to several minutes, and the fact that some devices may never transition (zero dark frequency).

### Output Interface

The output of the device is designed to drive a CMOS logic input over short distances. If lines greater than 12 inches in length are used on the output, a buffer or line driver is recommended.



## APPLICATION INFORMATION

### Measuring the Frequency

The choice of interface and measurement technique depends on the desired resolution and data-acquisition rate. For maximum data-acquisition rate, period-measurement techniques are used.

Period measurement requires the use of a fast reference clock with available resolution directly related to the reference-clock rate. The technique is employed to measure rapidly varying light levels or to make a fast measurement of a constant light source.

Maximum resolution and accuracy may be obtained using frequency-measurement, pulse-accumulation, or integration techniques. Frequency measurements provide the added benefit of averaging out random- or high-frequency variations (jitter) resulting from noise in the light signal. Resolution is limited mainly by available counter registers and allowable measurement time. Frequency measurement is well suited for slowly varying or constant light levels and for reading average light levels over short periods of time. Integration, the accumulation of pulses over a very long period of time, can be used to measure exposure — the amount of light present in an area over a given time period.

Output enable ( $\overline{OE}$ ) places the output in a high-impedance state for multiple-unit sharing of a microcontroller input line. When the  $\overline{OE}$  line goes low, the device resynchronizes the output to an integration cycle. The rising edge of the output signal (OUT) will occur exactly one period of the output frequency after  $\overline{OE}$  goes low.

### PCB Pad Layout

Suggested PCB pad layout guidelines for the T package are shown in Figure 10.

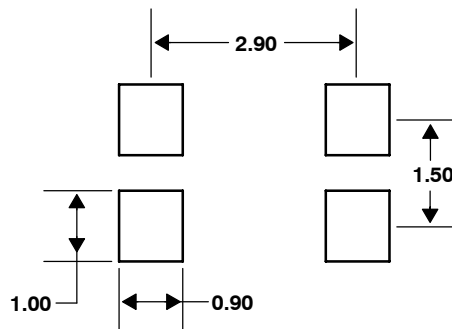

- NOTES: A. All linear dimensions are in millimeters.  
B. This drawing is subject to change without notice.

**Figure 10. Suggested T Package PCB Layout**

# TSL238T HIGH-SENSITIVITY LIGHT-TO-FREQUENCY CONVERTER

TAOS080G – DECEMBER 2007

## MECHANICAL DATA

The TSL238T is supplied in a low-profile surface-mount package. This package contains no lead (Pb).

### PACKAGE T

### Four-Lead Surface Mount Device

#### TOP VIEW

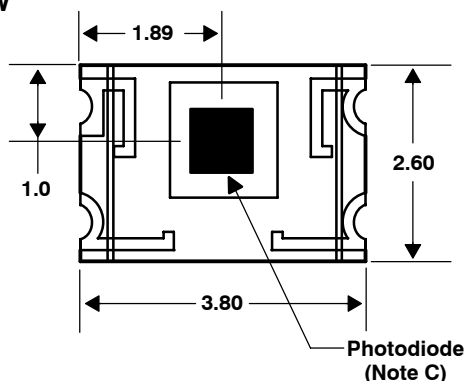

#### SIDE VIEW

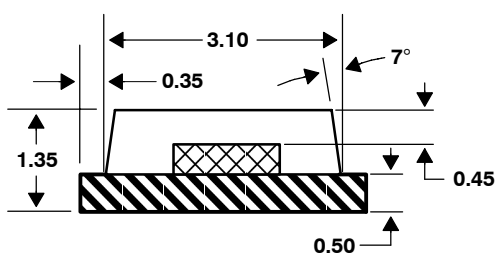

#### BOTTOM VIEW

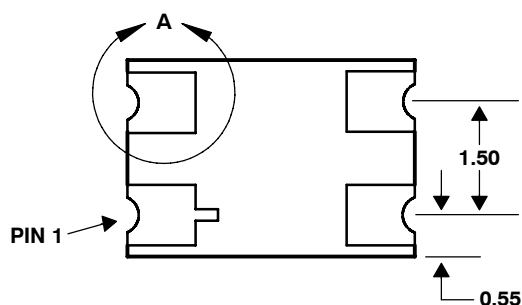

#### DETAIL A: TYPICAL PACKAGE TERMINAL

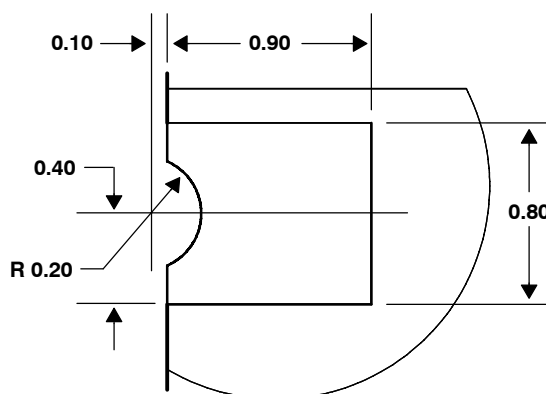

Lead Free

- NOTES: A. All linear dimensions are in millimeters.  
B. Terminal finish is gold, 1.3  $\mu\text{m}$  minimum.  
C. The center of the 0.84 mm  $\times$  0.84 mm integrated photodiode active area is referenced to the upper left corner of the package (near Pin 1).  
D. Dimension tolerance is  $\pm 0.15$  mm.  
E. This drawing is subject to change without notice.

**Figure 11. Package T — Four-Lead Surface Mount Device Packaging Configuration**



NOTES: A. All linear dimensions are in millimeters.  
B. The dimensions on this drawing are for illustrative purposes only. Dimensions of an actual carrier may vary slightly.  
C. Symbols on drawing A<sub>0</sub>, B<sub>0</sub>, and K<sub>0</sub> are defined in ANSI EIA Standard 481-B 2001.  
D. Each reel is 178 millimeters in diameter and contains 1000 parts.  
E. TAOS packaging tape and reel conform to the requirements of EIA Standard 481-B.  
F. In accordance with EIA standard, device pin 1 is located next to the sprocket holes in the tape.  
G. This drawing is subject to change without notice.

9

## MANUFACTURING INFORMATION

The reflow profile specified here describes expected maximum heat exposure of devices during the solder reflow process of the device on a PWB. Temperature is measured at the top of the device. Devices should be limited to one pass through the solder reflow profile.

**Table 1. TSL238T Solder Reflow Profile**

PARAMETER	REFERENCE	TSL238T
Average temperature gradient in preheating		2.5°C/sec
Soak time	$t_{\text{soak}}$	2 to 3 minutes
Time above $T_1$ , 217°C	$t_1$	Max 60 sec
Time above $T_2$ , 230°C	$t_2$	Max 50 sec
Time above $T_3$ , ( $T_{\text{peak}} - 10^\circ\text{C}$ )	$t_3$	Max 10 sec
Peak temperature in reflow	$T_{\text{peak}}$	260° C (–0°C/+5°C)
Temperature gradient in cooling		Max –5°C/sec

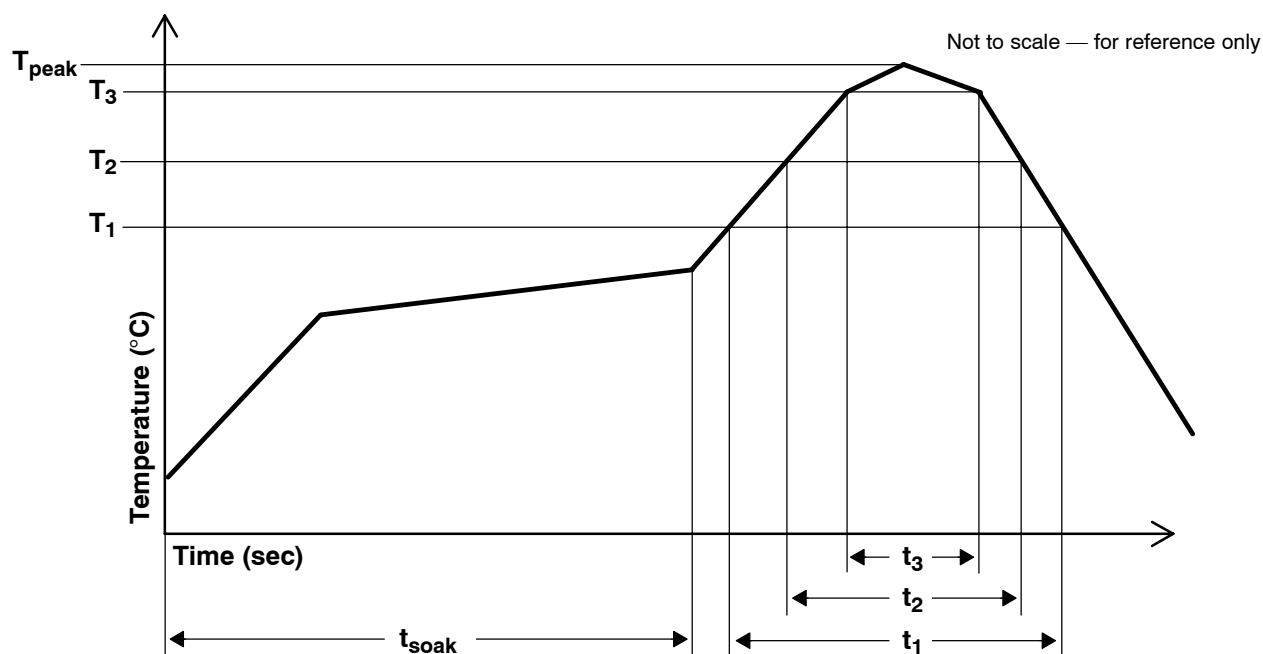

**Figure 13. TSL238T Solder Reflow Profile**

---

## MANUFACTURING INFORMATION

### Moisture Sensitivity

Optical characteristics of the device can be adversely affected during the soldering process by the release and vaporization of moisture that has been previously absorbed into the package molding compound. To ensure the package molding compound contains the smallest amount of absorbed moisture possible, each device is dry-baked prior to being packed for shipping. Devices are packed in a sealed aluminized envelope with silica gel to protect them from ambient moisture during shipping, handling, and storage before use.

This package has been assigned a moisture sensitivity level of MSL 3 and the devices should be stored under the following conditions:

Temperature Range	5°C to 50°C
Relative Humidity	60% maximum
Total Time	6 months from the date code on the aluminized envelope — if unopened
Opened Time	168 hours or fewer

Rebaking will be required if the devices have been stored unopened for more than 6 months or if the aluminized envelope has been open for more than 168 hours. If rebaking is required, it should be done at 90°C for 4 hours.

# TSL238T HIGH-SENSITIVITY LIGHT-TO-FREQUENCY CONVERTER

TAOS080G – DECEMBER 2007

---

**PRODUCTION DATA** — information in this document is current at publication date. Products conform to specifications in accordance with the terms of Texas Advanced Optoelectronic Solutions, Inc. standard warranty. Production processing does not necessarily include testing of all parameters.

## ***LEAD-FREE (Pb-FREE) and GREEN STATEMENT***

**Pb-Free (RoHS)** TAOS' terms *Lead-Free* or *Pb-Free* mean semiconductor products that are compatible with the current RoHS requirements for all 6 substances, including the requirement that lead not exceed 0.1% by weight in homogeneous materials. Where designed to be soldered at high temperatures, TAOS Pb-Free products are suitable for use in specified lead-free processes.

**Green (RoHS & no Sb/Br)** TAOS defines *Green* to mean Pb-Free (RoHS compatible), and free of Bromine (Br) and Antimony (Sb) based flame retardants (Br or Sb do not exceed 0.1% by weight in homogeneous material).

**Important Information and Disclaimer** The information provided in this statement represents TAOS' knowledge and belief as of the date that it is provided. TAOS bases its knowledge and belief on information provided by third parties, and makes no representation or warranty as to the accuracy of such information. Efforts are underway to better integrate information from third parties. TAOS has taken and continues to take reasonable steps to provide representative and accurate information but may not have conducted destructive testing or chemical analysis on incoming materials and chemicals. TAOS and TAOS suppliers consider certain information to be proprietary, and thus CAS numbers and other limited information may not be available for release.

## ***NOTICE***

Texas Advanced Optoelectronic Solutions, Inc. (TAOS) reserves the right to make changes to the products contained in this document to improve performance or for any other purpose, or to discontinue them without notice. Customers are advised to contact TAOS to obtain the latest product information before placing orders or designing TAOS products into systems.

TAOS assumes no responsibility for the use of any products or circuits described in this document or customer product design, conveys no license, either expressed or implied, under any patent or other right, and makes no representation that the circuits are free of patent infringement. TAOS further makes no claim as to the suitability of its products for any particular purpose, nor does TAOS assume any liability arising out of the use of any product or circuit, and specifically disclaims any and all liability, including without limitation consequential or incidental damages.

TEXAS ADVANCED OPTOELECTRONIC SOLUTIONS, INC. PRODUCTS ARE NOT DESIGNED OR INTENDED FOR USE IN CRITICAL APPLICATIONS IN WHICH THE FAILURE OR MALFUNCTION OF THE TAOS PRODUCT MAY RESULT IN PERSONAL INJURY OR DEATH. USE OF TAOS PRODUCTS IN LIFE SUPPORT SYSTEMS IS EXPRESSLY UNAUTHORIZED AND ANY SUCH USE BY A CUSTOMER IS COMPLETELY AT THE CUSTOMER'S RISK.

LUMENOLOGY, TAOS, the TAOS logo, and Texas Advanced Optoelectronic Solutions are registered trademarks of Texas Advanced Optoelectronic Solutions Incorporated.





**Стандарт  
Электрон  
Связь**

Мы молодая и активно развивающаяся компания в области поставок электронных компонентов. Мы поставляем электронные компоненты отечественного и импортного производства напрямую от производителей и с крупнейших складов мира.

Благодаря сотрудничеству с мировыми поставщиками мы осуществляем комплексные и плановые поставки широчайшего спектра электронных компонентов.

Собственная эффективная логистика и склад в обеспечивает надежную поставку продукции в точно указанные сроки по всей России.

Мы осуществляем техническую поддержку нашим клиентам и предпродажную проверку качества продукции. На все поставляемые продукты мы предоставляем гарантию .

Осуществляем поставки продукции под контролем ВП МО РФ на предприятия военно-промышленного комплекса России , а также работаем в рамках 275 ФЗ с открытием отдельных счетов в уполномоченном банке. Система менеджмента качества компании соответствует требованиям ГОСТ ISO 9001.

Минимальные сроки поставки, гибкие цены, неограниченный ассортимент и индивидуальный подход к клиентам являются основой для выстраивания долгосрочного и эффективного сотрудничества с предприятиями радиоэлектронной промышленности, предприятиями ВПК и научно-исследовательскими институтами России.

С нами вы становитесь еще успешнее!

**Наши контакты:**

**Телефон:** +7 812 627 14 35

**Электронная почта:** [sales@st-electron.ru](mailto:sales@st-electron.ru)

**Адрес:** 198099, Санкт-Петербург,  
Промышленная ул, дом № 19, литера Н,  
помещение 100-Н Офис 331